



**CITY OF GRANDVIEW  
NOTICE OF DEVELOPMENT APPLICATION  
ENVIRONMENTAL DETERMINATION & NOTICE OF PUBLIC HEARING**

The general public is hereby provided notice of the following development application, pursuant to Grandview Municipal Code (GMC) 14.07 and Washington Administrative Code (WAC) 197-11-355:

**Applicant(s):** Charvet Brothers Farms, a partnership composed of Matthew & Lydia Charvet and Terry & Leslie Charvet, and Kyle & Cyndi Charvet  
**Proposed Project:** Annexation & Rezone  
**Application Date:** August 1, 2019  
**Application Acceptance:** September 10, 2019  
**Decision-Making Authority:** City of Grandview

**Location of Project:** : Parcel Nos. 230926-21002, 230926-21003, 230926-24003, 230926-22010, 230926-22011, 230926-23008, 230926-23009, and 230926-24004, located adjacent to Grandridge Road/Apricot Road, Grandview, Yakima County, Washington

**Project Description:** Applicants request annexation and rezone to R-1 Low Density Residential

**Requested Approvals & Actions:** Annexation and Rezone to R-1 Low Density Residential

**Existing Environmental Documents:** An Environmental Checklist has been prepared and is available from the City upon request.

A decision on this application will be made within 120 days of the date of the letter of completeness.

**Environmental Determination**

The City of Grandview is the lead agency for this application, and intends to issue a Determination of Non-Significance. The City is utilizing the optional DNS process set forth in WAC 197-11-355. This may be the only opportunity to comment on the environmental impacts of this proposal. The proposal may include mitigation measures under applicable codes, and the project review process may incorporate or require mitigation measures regardless of whether an Environmental Impact Statement is prepared. The City will review all timely comments prior to making a final threshold determination. Any person has the right to comment on the application, and receive notice of and participate in any hearings on the application, if any are scheduled or held. At this time, the City does not intend to hold a public hearing to consider the environmental aspects of this application. A copy of the threshold determination ultimately issued with respect to this application may be obtained upon request. Comments on

the environmental impacts of this proposal must be received by **WEDNESDAY, SEPTEMBER 25, 2019**.

#### **Comment Period and Where to View Documents**

The development application and environmental checklist may be viewed at the City of Grandview, 207 West Second Street, Grandview, WA. All interested persons are invited to (a) comment on the application, (b) receive notice of and participate in any hearings, and (c) receive a copy of the decision by submitting such written comments/requests to the City of Grandview, Attn: City Clerk, 207 West Second Street, Grandview, WA 98930, ph: (509) 882-9208. Comments concerning the application should be submitted no later than **WEDNESDAY, SEPTEMBER 25, 2019**. While comments will be accepted through closing of the public hearing on this proposal, comments received after **WEDNESDAY, SEPTEMBER 25, 2019** may not be considered in the staff report.

#### **Public Hearing**

The City of Grandview Hearing Examiner will hold a public hearing pursuant to GMC 14.03 on **WEDNESDAY, OCTOBER 9, 2019 at 3:00 p.m.**, in the Council Chamber at City Hall, 207 West Second Street, Grandview, Washington. The public hearing will consider the application of the project described above. To request accommodation for special needs, contact Anita Palacios, City Clerk, 24-hours in advance at (509) 882-9208. Interpreters will be available upon request. The Council Chamber is handicapped accessible. American Disabilities Act (ADA) accommodations provided upon request 24-hours in advance.

#### **CITY OF GRANDVIEW**

Anita G. Palacios, MMC, City Clerk

Publication: Grandview Herald – September 11, 2019

# Yakima County GIS - Washington Land Information Portal

[\[Print Map\]](#)  
[\[Close Map\]](#)

[Yakimap.com](http://www.yakimap.com)

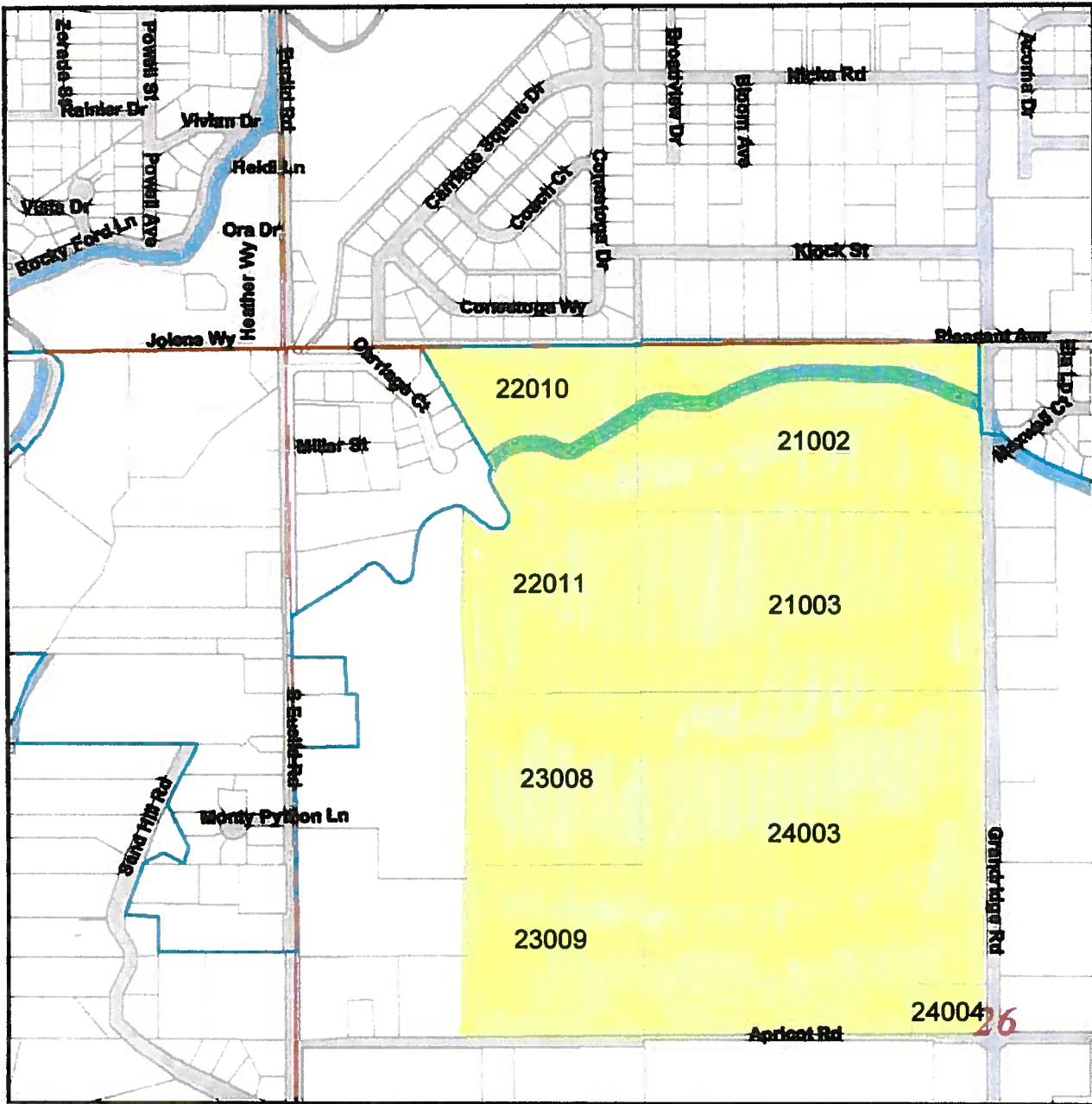

Map Center: Range:23 Township:9 Section:26

— City Limits  
— Sections

[WWW.YAKIMAP.COM](http://WWW.YAKIMAP.COM)

Yakima County GIS  
 128 N 2nd Street  
 Yakima, WA 98901  
 (509)574-2992



One Inch = 600 Feet  
 Feet 250 500 750 1000

MAP AND PARCEL DATA ARE BELIEVED TO BE ACCURATE, BUT ACCURACY IS NOT GUARANTEED; THIS IS NOT A LEGAL DOCUMENT AND SHOULD NOT BE SUBSTITUTED FOR A TITLE SEARCH, APPRAISAL, SURVEY, FLOODPLAIN OR ZONING VERIFICATION

Copyright (C) Yakima County GIS  
 Printed On: 8/15/2017 2:45:57 PM